

# Broaching Nuts

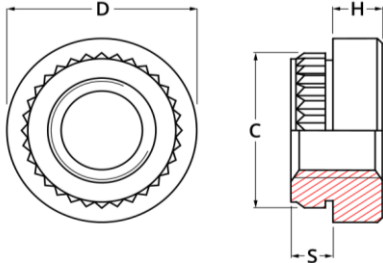

Broaching Nuts							
Thread And Pitch	Min Panel Thickness	S Max.	C + 0.08 / - 0.08	D + 0.08 / - 0.08	H + 0.13 / -0.13	Hole Size + 0.08 / -0.0	Min. CL To Edge Of Panel
M2 x 0.4	1.53	1.53	4.19	5.56	1.50	3.73	4.20
M2.5 x 0.45	1.53	1.53	4.68	5.56	1.50	4.22	4.40
M3 x 0.5	1.53	1.53	4.68	5.56	1.50	4.22	4.40
M3.5 x 0.6	1.53	1.53	5.87	7.17	2.00	5.41	5.50
M4 x 0.7	1.53	1.53	6.86	8.74	2.00	6.40	6.40
M5 x 0.8	1.53	1.53	7.47	9.53	3.00	6.90	7.10

Material
Steel Electro Tin Plated Stainless Steel (A2)
Maximum Reccomended Panel Hardness 60HRB

INFORMATION AND DRAWINGS PROVIDED ARE FOR REFERENCE ONLY